

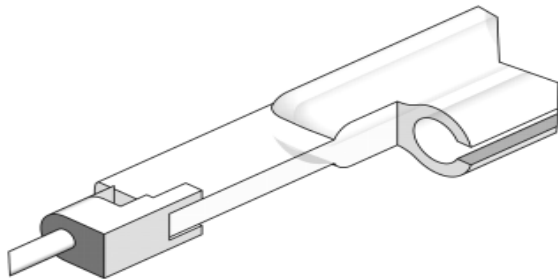

Infrared Slot Emitter

Infrared emitters transfer large amounts of energy within short time. Infrared emitter with a slot in one of the tubes, working like a drying or heating channel for fibres or ropes. A gold reflector additionally increases efficiency. The optimum solution for chemical fibres and textile threads. The special slot design makes drying very intensive and efficient.



Features

- Saving of energy
- Saving of space
- In-line heat processing

Technical Data

- Quartz glass
- Cross section 23x11mm
Slot width 3mm
- Cross section 34x14mm
Slot width 4mm
- Slot length up to 1000mm
longer emitters on request
- gold coating around the whole emitter
- from NIR to medium wave
- response time within seconds
- Vertical and horizontal use
- Two side electrical connection
- Maximum power 40W/cm

Every emitter type can be modified for the benefit of your process. Heating only where it is required, with the optimum wavelength for the product to be heated and in harmony with the process.
Contact us!

South Korea
Heraeus Korea Corp
13F, 156, Gwanggyo-ro
(Eui-dong, Gwanggyo business center)
Yeongtong-gu, Suwon-shi, Gyeonggi-do, 16506
Phone +82-31-270-9442
Fax +82-31-8064-1847
hng-hk@heraeus.com
www.heraeus-noblelight.com